

CALIFORNIA HEALTH FACILITIES FINANCING AUTHORITY (Authority)

**Community Services Infrastructure Grant Program
Resolution Number CSI 2019-01 (First Funding Round) and
Resolution Number CSI 2020-03 (Second Funding Round)
County of Los Angeles, Office of Diversion and Reentry**

July 30, 2020

PURPOSE OF THE REQUEST:

The County of Los Angeles, Office of Diversion and Reentry (County) is requesting to alter the scope of both of its approved Community Services Infrastructure (CSI) Grant Program projects.

BACKGROUND:

The County submitted two CSI project applications that were approved by the Authority during two competitive funding rounds.

1st CSI Grant: Bell Recuperative Care Center (Round 1):

Resolution Number CSI 2019-01, approved by the Authority on July 25, 2019, authorized a CSI grant for the County in the amount of \$6,000,000 to add at least 75 new beds in a new jail diversion program that would provide mental health treatment, substance use disorder treatment, and trauma-centered services to approximately 225 clients annually. Grant funds would have been used for renovation costs only, and the total cost of the project was \$9,029,298. The project was scheduled to be open and operational by October 31, 2021.

2nd CSI Grant: Olive View-UCLA Medical Center Psychiatric Bed Expansion (Round 2):

Resolution Number CSI 2020-03, approved by the Authority on March 26, 2020, authorized a CSI grant for the County in the amount of \$5,300,945 to add at least 25 new beds in an expanded jail diversion program that would provide mental health treatment, substance use disorder treatment, and trauma-centered services to at least 340 clients annually. Grant funds would have been used for renovation costs and for furnishings and equipment costs, and the total cost of the project was \$5,974,345. The project was scheduled to be open and operational by June 30, 2022.

ISSUE:

According to the County, it has worked diligently toward the development and implementation of the approved CSI projects that would meet the CSI program requirements and approved timeframes. However, since the outbreak of the COVID-19 pandemic, the County encountered some challenges that would jeopardize the timeline and feasibility of the approved CSI projects. The two main challenges are a loss in County revenue and anticipated delays in obtaining a conditional use permit for one of the projects.

The loss in revenue affects the County's operational budget, while the delayed project completion schedule in construction could jeopardize the County's ability to meet the CSI Grant Program's deadline, currently statutorily set for June 30, 2022, which means all projects must be completed, be operational, and be fully disbursed prior to that date.

1st CSI Grant: Bell Recuperative Care Center:

The original project scope was to renovate a 100-bed psychiatric recuperative care interim housing site at the Salvation Army Bell Shelter in the City of Bell, of which 75-beds, funded by the CSI grant, would have been dedicated to justice-involved individuals. At the time of the CSI grant application, the County was advised by the Salvation Army that a conditional use permit was not needed for the proposed project. During the readiness phase of the project, the City of Bell informed the County that the project did require a conditional use permit, which would push back the start of construction. Additionally, the project would have required the County to enter a long-term lease with the Salvation Army, which was no longer financially viable due to the COVID-19 pandemic, resulting in a loss of revenue for the County.

2nd CSI Grant: Olive View-UCLA Medical Center Psychiatric Bed Expansion:

The original project scope was to add 25 psychiatric beds to serve the justice-involved population. The County has determined that the operating costs of expanding inpatient psychiatric beds is significant, and the additional psychiatric beds would have required a considerable county contribution, which is no longer anticipated to be available due to the impact of the COVID-19 pandemic on County revenues, resulting in a loss of revenue.

NEW PROPOSED MODIFIED PROJECT:

In an effort fill the gap in the continuum of care and expand community alternatives to incarceration, the County re-evaluated its existing resources and is requesting to alter its initially approved projects to more feasible ones despite the revenue losses.

1st CSI Grant: LAC+USC Medical Center Recuperative Care Center:

The County is requesting to reduce the number of beds and change the location of the Bell Recuperative Center to a County-owned location, the LAC+USC campus, that is part of a bigger project where construction/renovation has already begun in July 2020. The total cost of the new Recuperative Care Center facility is \$24,145,000 for 96 beds, of which the awarded CSI grant of \$6,000,000 would fund 24 beds dedicated to the target population of justice-involved individuals to provide mental health treatment, substance use disorder treatment and trauma-centered services. The new proposed 24 beds would serve approximately 144 clients annually. The County would like to maintain all funding for this project, change the project location, and reduce the initial approved bed count by 51 beds.

The LAC+USC campus is also the location where four Crisis Residential Treatment (CRTP) projects are being simultaneously developed and funded with Investment in Mental Health Grant Program (IMHWGP) grants. The IMHWGP projects and the CSI project have separate locations on the LAC+USC campus, as well as separate construction budgets and timelines (see Attachment 2 and 3).

2nd CSI Grant: Olive View-UCLA Medical Center Recuperative Care Center:

The County is proposing to reduce the number of beds approved in the initial project and make a change in the type of services provided. The proposed Olive View Medical Center Recuperative Care Center would be located in a two-story modular building on County-owned land, which is already under construction. The total cost of the new 48-beds facility is \$20,537,000, of which the awarded CSI grant of \$5,300,945 would fund 12 beds dedicated to the target population of justice-

involved individuals to provide mental health treatment, substance use disorder treatment and trauma-centered services. The 12 new beds would serve approximately 72 clients annually. Psychiatric recuperative care services would be provided to ensure continuity of care for justice-involved clients residing in the existing 18-bed psychiatric unit. The County would like to maintain all funding for this project, reduce the initial proposed bed count by 13 beds, and not provide psychiatric inpatient services any longer.

The Olive View campus is also the location where five CRTP’s projects and one Crisis Stabilization Unit project are being developed that are funded with IMHWGP grants. The IMHWGP project and the CSI project would have separate locations on the Olive View campus, as well as separate construction budgets and timelines (see Attachment 5 and 6).

| | Initial Project | | New Project | |
|---------------------------|-----------------|-------------------|-------------|-------------------|
| | Bed Count | Population Served | Bed Count | Population Served |
| Round 1 | 75 | 225 | 24 | 144 |
| Round 2 | 25 | 340 | 12 | 72 |
| Total CHFFA funded | 100 | 565 | 36 | 216 |

PROGRESS:

The new CSI projects would be located at two County-owned locations where construction for IMHWGP projects is currently under way. The County has already begun the pre-construction processes at both locations, which would allow the County to implement the CSI projects more quickly. A new budget and timeline were developed for each site, and the projects are scheduled to be open and operational by June 2022.

The CSI program deadline is currently statutorily set for June 30, 2022, which means all projects must be completed, be operational, and be fully disbursed prior to that date. Any funds that are not disbursed by the deadline or are forfeited will automatically revert to the general fund.

NEXT STEPS:

Authority staff has concerns regarding the County’s proposed changes to the initial approved CSI projects, not only the reduction in the number of beds, but also the new projects appear to be integrated into already pre-existing projects that are underway, raising concerns about the use of funds.

In light of the challenges that all the counties are facing due to the COVID-19 pandemic and the potential for other grantees to request CSI project changes, staff is seeking general direction from the Board regarding the County’s proposed changes to the CSI projects, as well as specific project parameters that the Board is willing to entertain. Below are potential options that may be considered:

1. Direct staff to further discuss changes to the projects with County, providing staff with direction as to what terms might be acceptable to the board.

2. Do not support the proposed changes and direct staff to deny the new projects. This would mean the County would likely forfeit the funding due to the financial and contractual challenges, and grant funds would revert back to the general fund.
3. Support the proposed changes and direct staff to prepare approval of the project changes for an upcoming Authority meeting, allowing the County to keep the full grant award amount.
4. Support the proposed changes with reduced grant funding, and direct staff to prepare approval of the project changes for an upcoming Authority meeting with a reduced grant award amount proportionate to the bed reduction. The remaining funds would revert back to the general fund.
5. Direct staff to engage in statutory changes to the CSI deadline in order to be able to open a third CSI funding round with any forfeited funds.

ATTACHMENTS:

1. Round 1 – County’s request for project change
2. Round 1 – New Budget and Timeline
3. Round 1 – New Site Plan
4. Round 2 – County’s request for project change
5. Round 2 – New Budget and Timeline
6. Round 2 – Site Plan
7. Round 1 & 2 - Project Comparison
8. Round 1 & 2 - Services Comparison



June 1, 2020

**Los Angeles County
Board of Supervisors**

Hilda L. Solis
First District

Mark Ridley-Thomas
Second District

Sheila Kuehl
Third District

Janice Hahn
Fourth District

Kathryn Barger
Fifth District

Christina R. Ghaly, M.D.
Director

Hal F. Yee, Jr., M.D., Ph.D.
Chief Deputy Director, Clinical Affairs

Nina J. Park, M.D.
Chief Deputy Director, Population Health

Frank Moore, Executive Director
California Health Facilities Financing Authority
915 Capitol Mall, Room 435
Sacramento, CA 95814

RE: **CHFFA FUNDS**

Dear Mr. Moore

The County of Los Angeles (County) Department of Health Services (DHS) Office of Diversion and Reentry (ODR) is requesting a change to the project scope for the grant awarded on July 25, 2019 in the amount of \$6,000,000 for the first round of funding for the Community Services Infrastructure. The original project scope was to renovate a 100-bed psychiatric recuperative care interim housing site at the Salvation Army Bell Shelter in the City of Bell, of the 100 beds, 75 would be dedicated to justice involved individuals.

During the readiness stage of this project, the County and our partner JWCH Institute (JWCH) have encountered challenges that would jeopardize the timeline of the project. The City of Bell has informed DHS that the project will require a Conditional Use Permit which would push back the start date of construction. Additionally, the project would require the County to enter into a long-term lease with the Salvation Army which is no longer financially viable to the County due to COVID-19 and the resulting loss of revenue.

The County would like to change the project scope to funding capital costs for LAC+USC Medical Center Recuperative Care Center (LAC+USC RCC). The LAC+USC RCC will be built on County land and will include 96 beds. The total cost of the project is \$24,145,000, and with the grant amount of \$6,000,000, 24 beds would be dedicated to justice involved individuals leaving County jails. All 24 beds will have access to mental health treatment, substance use disorder treatment and/or trauma centered services. The scheduled completion date of LAC+USC RCC is May 2021.

If you have any questions or need any additional information, please contact Rose Sunderland of my staff at (213) 418-3604.

Respectfully,

Christina R. Ghaly, M.D.
Director

CRG:rs

c: Contracts and Grants Division

313 N. Figueroa Street, Suite 912
Los Angeles, CA 90012

Tel: (213) 288-8050
Fax: (213) 481-0503

www.dhs.lacounty.gov

*"To advance the health of our
patients and our communities by
providing extraordinary care"*



www.dhs.lacounty.gov

ENCLOSURE A

**CONSTRUCTION CONTRACT
 PUBLIC BUILDINGS CORE SERVICE AREA
 LAC+USC MEDICAL CENTER
 RESTORATIVE CARE VILLAGE PROJECTS
 APPROVE PROJECT BUDGETS
 APPROPRIATION ADJUSTMENT AND
 AWARD DESIGN-BUILD CONTRACT
 SPECS. 7552; CAPITAL PROJECT NO. 69870
 SPECS. 7549; CAPITAL PROJECT NO. 69863
 (SUPERVISORIAL DISTRICT 1)
 (4 VOTES)**

I. PROJECT SCHEDULE SUMMARY – RCC – C.P. NO. 69863

| Project Activity | Scheduled Completion Date |
|-------------------------|----------------------------------|
| Environmental Document | 12/17* |
| Scoping Documents | 06/19 |
| Design-Build Award | 11/19 |
| Construction Start | 04/20 |
| Substantial Completion | 02/21 |
| Project Close-out | 05/21 |

*Completed activity.

II. PROJECT BUDGET SUMMARY – RCC

| Budget Category | Total |
|----------------------------------------------|----------------------|
| Hard Costs | |
| Construction (Design-Build) | \$ 18,617,000 |
| Contingency | \$ 2,816,000 |
| Construction Subtotal | \$ 21,433,000 |
| Civic Art | \$ 190,000 |
| Equipment | \$ 60,000 |
| Hard Costs Subtotal | \$ 21,683,000 |
| Soft Costs | |
| Plans and Specifications | \$ 299,000 |
| Consultant Services | \$ 305,000 |
| Miscellaneous Expenditure | \$ 117,000 |
| Jurisdictional Review, Plan Check and Permit | \$ 470,000 |
| County Services | \$ 1,270,270 |
| Soft Costs Subtotal | \$ 2,462,000 |
| TOTAL | \$ 24,145,000 |

SITE GENERAL NOTES

- IT IS THE OWNER'S INTENT THAT ALL ACCESSIBLE PARKING AND CLIENT REQUIRED VAN PARKING BE LOCATED ON SITE. AMBLANCE PARKING CAN BE LOCATED ON ZONAL AVENUE. THIS MUST BE COORDINATED WITH UPV AND APPROPRIATE AUTHORITIES HAVING JURISDICTION OVERS. NOTE THAT THE PROJECT IS LOCATED IN THE CITY OF LA, AND THEREFORE OFF-SITE WORK MAY NEED TO BE COORDINATED WITH ALL TRIPLE JURISDICTIONS. ALL OTHER REQUIRED PARKING SPACES SHALL BE LOCATED IN OTHER LACUSC CAMPUS PARKING FACILITIES. THE DS SHALL COORDINATE CLOSELY WITH CPV FOR LOUISIANA PARKING.
- THE DS, TOGETHER WITH THE DEPARTMENT OF PUBLIC WORKS SHALL SURVEY THE SITE PRIOR TO MOBILIZATION TO ASCERTAIN THE EXISTING CONDITIONS. THE DS SHALL BE RESPONSIBLE FOR OBTAINING ALL SURFACE DRAINAGE BY CONSTRUCTION ACTIVITIES.
- THE DS SHALL MAINTAIN PROPER ACCESS TO ALL FACILITIES BEYOND THE LIMIT OF CONSTRUCTION WORK DURING CONSTRUCTION. EXISTING ONE WAY SIGN SHALL BE RETAINED AND PROTECTED IN PLACE OR FOLLOW THE GUIDELINES SET FORTH IN THE AIRBORNE REPORT AND REQUIREMENTS OF THE AAL.
- ALL HARDWARE SHALL BE DESIGNED AND CONSTRUCTED TO DETER VANDALISM INCLUDING DETRIMENT OF SHAKE-RESISTANCE.
- BUILDING DIMENSIONS ARE TO EDGE OF SLAB / FACE OF STUD.
- BUILDING LOCATIONAL DIMENSIONS ARE TO EDGE OF SLAB / FACE OF STUD.

SIGNAGE AND GRAPHICS

- ALL SIGNAGE DURING CONSTRUCTION SHALL BE AS REQUIRED BY THE LOS ANGELES COUNTY AND ALL OTHER GOVERNING AGENCIES.
- ALL OTHER SIGNAGE REQUIREMENTS PER BUILDING CODE REQUIREMENTS.
- SIGNAGE SHALL FOLLOW GUIDELINES FOR THE LAC-USC MEDICAL CAMPUS MASTER PLAN.
- AN ILLUMINATED MONUMENT SIGN SHALL BE LOCATED ON ZONAL AVENUE. THE SIGN SHALL IDENTIFY THE SITE AS THE RESTORATIVE CARE VILLAGE, AND SHALL NOT IDENTIFY THE NAMES OF THE FACILITIES.
- BUILDING ADDRESS SIGN SHALL BE LOCATED ON EACH BUILDING AND BE VISIBLE FROM THE STREET. IT SHALL MATCH THE STYLE OF THE BUILDING SIGNAGE AND MEET FIRE DEPARTMENT REQUIREMENTS. ADDRESS SIGNAGE SHALL NOT BE LESS THAN 1/2".
- BUILDING SIGNAGE SHALL BE MOUNTED ON THE BUILDING WITH PROPER ILLUMINATION. MINIMUM LETTER SIZE SHALL BE 1/2". BUILDING SIGNAGE SHALL BE EARLY BEEN FROM THE INTERIOR SIDE OF THE SITE.
- A COMPLETE SCHEDULE OF SIGNAGE AND GRAPHICS, WITH SAMPLE LAYOUTS AND COLORS, SHALL BE SUBMITTED FOR APPROVAL PRIOR TO INSTALLATION.

SITE PLAN KEYNOTES

- NEW ILLUMINATED MONUMENT SIGN
- SHORT-TERM BIKE PARKING SIGN
- LONG-TERM BIKE PARKING SIGN
- TRASH ENCLOSURE (40 S.F.)
- STORAGE BUILDINGS (20 S.F., EACH)
- TOW-AWAY SIGN
- FIRE HYDRANT
- FIRE HYDRANT TO BE RELOCATED
- RELOCATED FIRE HYDRANT
- WATER SERVICES MANHOLE TO REMAIN. WATER SERVICE PIPING TO BE RE-ROUTED PER UTILITY PLAN.
- STAIRS (NOT IN SCOPE)
- RCC
- LOADING SPACE (12'X3')
- TRANSFORMER - SEE ELECTRICAL DRAWINGS
- 4'-0" HIGH FENCE - SEE SITE DETAILS

SITE PLAN LEGEND

- (E) BUILDING NOT IN SCOPE
- LANDSCAPE / PLANTING AREA
- DECOMPOSED GRANITE
- GATHERING LAWN
- PROPERTY LINE
- SCOPE OF WORK BOUNDARY
- PATH OF TRAVEL
- 4'-0" HIGH FENCE - SEE SITE DETAILS
- (E) RETAINING WALL TO REMAIN
- PORTION OF (E) RETAINING WALL TO BE REMOVED
- (N) RETAINING WALL - SEE CIVIL DWGS
- (N) TREE PER LANDSCAPE DWGS
- (E) OAK TREE TO REMAIN SEE LANDSCAPE DWGS.
- FIRE HYDRANT
- FIXED CHAIR - SEE LANDSCAPE DWGS
- FIXED BENCH - SEE LANDSCAPE DWGS

ZONING CODE ANALYSIS

ADDRESS INFO:
1774 E. ZONAL AVENUE
LOS ANGELES, CA 90033
APN: 5205-020-001

SITE AREA:
87,200 SF (2 ACRES)

ZONING:
RTP - CITY OF LOS ANGELES
INSTITUTIONAL (COUNTY OF LOS ANGELES)

SETBACKS: NONE
HEIGHT: NONE

BICYCLE PARKING:
PER LOS ANGELES COUNTY MUNICIPAL CODE 22.02.1100

SHORT TERM: 1 PER 20,000 SF GROSS AREA (2 MINIMUM)
RTP: 2 REQUIRED & PROVIDED PER BUILDING
TOTAL PROVIDED: 12

LONG TERM: 1 PER 10,000 SF GROSS AREA (2 MINIMUM)
RTP: 2 REQUIRED & PROVIDED PER BUILDING
RCC: 4 REQUIRED & PROVIDED PER BUILDING
TOTAL PROVIDED: 12

LOADING SPACES:
TOTAL OF (3) TYPE "A"

VEHICLE LAIR PARKING:
PER LOS ANGELES COUNTY MUNICIPAL CODE 22.02.1100
1 SPACE PER 100 SF OF COMMERCIAL FLOOR AREA
RTP TOTAL DORMITORY AREA: 1,400 SF
RCC TOTAL DORMITORY AREA: 8,800 SF

| PARKING TABLE | REQUIRED | | ACTUAL ON-SITE | |
|----------------|----------------|-----------|----------------|-----------|
| | RTP (X-4) | RCC | RTP (X-4) | RCC |
| STANDARD (ADA) | 14 (00) | 64 | 1 | 1 |
| STANDARD (ADA) | 0 (0) | 2 | 0 (0) | 2 |
| VAN (ADA) | 1 (4) | 1 | 2 (0) | 3 |
| TOTAL | 15 (00) | 67 | 3* | 6* |

* 112 PARKING SPACES RESERVED FOR THIS PROJECT WILL BE LOCATED IN CAMPUS PARKING LOT/STRUCTURES. SEE LOCATION MAP ON DISK.



LAC + USC
RESTORATIVE CARE VILLAGE
1774 ZONAL AVENUE
LOS ANGELES, CA 90033

CANNON DESIGN

- OWNER:**
LA COUNTY DEPARTMENT OF PUBLIC WORKS
800 S. Fremont Avenue
Inglewood, CA
91603 621-500-3343
- CIVIL:**
CORNERSTONE LAND SURVEYING INC.
20700 Ford Place
Palo Alto, CA 94303
651-738-0200
- LANDSCAPE:**
MELI
871 S. GARDEN CITY, SUITE 110
LOS ANGELES, CA 90014
719-253-2007
- STRUCTURAL:**
CANNON DESIGN
50 Bunker Street, Suite 600
Boston, MA 02119
781-743-9278
- MECHANICAL:**
SOUTHLAND ENGINEERING
12111 Wilshire Avenue
Gardena, CA 90247
714-601-5000
- ELECTRICAL:**
HANDALL LAW ASSOCIATES, INC.
4757 Park Avenue La Mesa, CA
619-418-734700

DMH - APPROVED RTP BUILDINGS AS SHOWN WITHOUT CHANGES
ALDRIC LOGAN - 3/20/20



2-10-20
JCI SECURITY
EMERGENCY PHONES
MATTHEW MCL AND RICH

100% CD SUBMITTAL 13 JAN 2020
Rev. Description Date

Drawing Title:
SITE PLAN
Project No.: 280304.00 Created by:
A0051

Attachment 3

© 2019 The Cannon Corporation
All rights reserved. No part of this document may be reproduced or transmitted in any form or by any means electronic or mechanical, including photocopying, recording, or by any information storage and retrieval system, without authorization by The Cannon Corporation.



Health Services
LOS ANGELES COUNTY

June 2, 2020

**Los Angeles County
Board of Supervisors**

Hilda L. Solis
First District

Mark Ridley-Thomas
Second District

Sheila Kuehl
Third District

Janice Hahn
Fourth District

Kathryn Barger
Fifth District

Christina R. Ghaly, M.D.
Director

Hal F. Yee, Jr., M.D., Ph.D.
Chief Deputy Director, Clinical Affairs

Nina J. Park, M.D.
Chief Deputy Director, Population Health

Frank Moore, Executive Director
California Health Facilities Financing Authority
915 Capitol Mall, Room 435
Sacramento, CA 95814

RE: CHFFA FUNDS

Dear Mr. Moore

The County of Los Angeles (County) Department of Health Services (DHS) Office of Diversion and Reentry (ODR) is requesting a change to the project scope for the grant awarded on March 26, 2020 in the amount of \$5,300,945 for the second round of funding for the Community Services Infrastructure to expand Olive View-UCLA Medical Center (OVMC) 6C/D by adding 25 psychiatric beds to serve the justice involved population. The operating cost of inpatient psychiatric beds is significant and the 6C/D beds would have required net county contribution which is no longer anticipated to be available due to COVID-19 and the resulting loss of revenue.

The County would like to change the project scope to funding capital costs for the OVMC Recuperative Care Center (OVMC RCC). The OVMC RCC will be built on County land and will be a two-story modular building with 48 beds. The total cost of the project is \$20,537,000, and with the grant amount of \$5,300,945, 12 beds would be dedicated to justice involved individuals leaving County jails. All 12 beds will have access to mental health treatment, substance use disorder treatment and/or trauma centered services. OVMC RCC will provide psychiatric recuperative care services to ensure continuity of care for justice involved clients residing in the current 18 bed 6C psychiatric unit. The scheduled completion date of the OVMC RCC is September 2021.

If you have any questions or need any additional information, please contact Rose Sunderland of my staff at (213) 418-3604.

Respectfully,

Christina R. Ghaly, M.D.
Director

CRG:rs

c: Contracts and Grants Division

313 N. Figueroa Street, Suite 912
Los Angeles, CA 90012

Tel: (213) 288-8050

Fax: (213) 481-0503

www.dhs.lacounty.gov

*"To advance the health of our
patients and our communities by
providing extraordinary care"*



www.dhs.lacounty.gov

ENCLOSURE A

**CONSTRUCTION CONTRACT
PUBLIC BUILDINGS CORE SERVICE AREA
OLIVE VIEW CAMPUS RECUPERATIVE CARE CENTER
AND RESIDENTIAL TREATMENT PROGRAM
APPROVE PROJECTS AND APPROPRIATION ADJUSTMENT
AUTHORIZE USE OF JOB ORDER CONTRACTING
AWARD DESIGN-BUILD CONTACT
SPECS. 7550; CAPITAL PROJECT NO. 69864
SPECS. 7554; CAPITAL PROJECT NO. 69872
(SUPERVISORIAL DISTRICTS 3 AND 5)
(4 VOTES)**

PROJECT SCHEDULE SUMMARY – RCC

| Project Activity | Scheduled Completion Date |
|-----------------------------|----------------------------------|
| Project Scoping Documents | 05/19 |
| Award Design-Build Contract | 10/19 |
| Construction Documents | By Design-Builder |
| Jurisdictional Approvals | By Design-Builder |
| Construction Start | 02/01/20 |
| Substantial Completion | 07/30/21 |
| Final Acceptance | 09/30/21 |

*Completed activity.

PROJECT BUDGET SUMMARY – RCC

| Budget Category | Total |
|----------------------------------------------|----------------------|
| Hard Costs | |
| Construction (Design-Build) | \$ 16,789,025 |
| Contingency | \$ 1,494,815 |
| Construction Subtotal | \$ 18,283,840 |
| Civic Art | \$ 169,690 |
| Hard Costs Subtotal | \$ 18,453,530 |
| Equipment | \$ 60,000 |
| Plans and Specifications | \$ 180,000 |
| Consultant Services | \$ 310,125 |
| Miscellaneous Expenditure | \$ 45,598 |
| Jurisdictional Review, Plan Check and Permit | \$ 636,409 |
| County Services | \$ 851,338 |
| Total | \$ 20,537,000 |

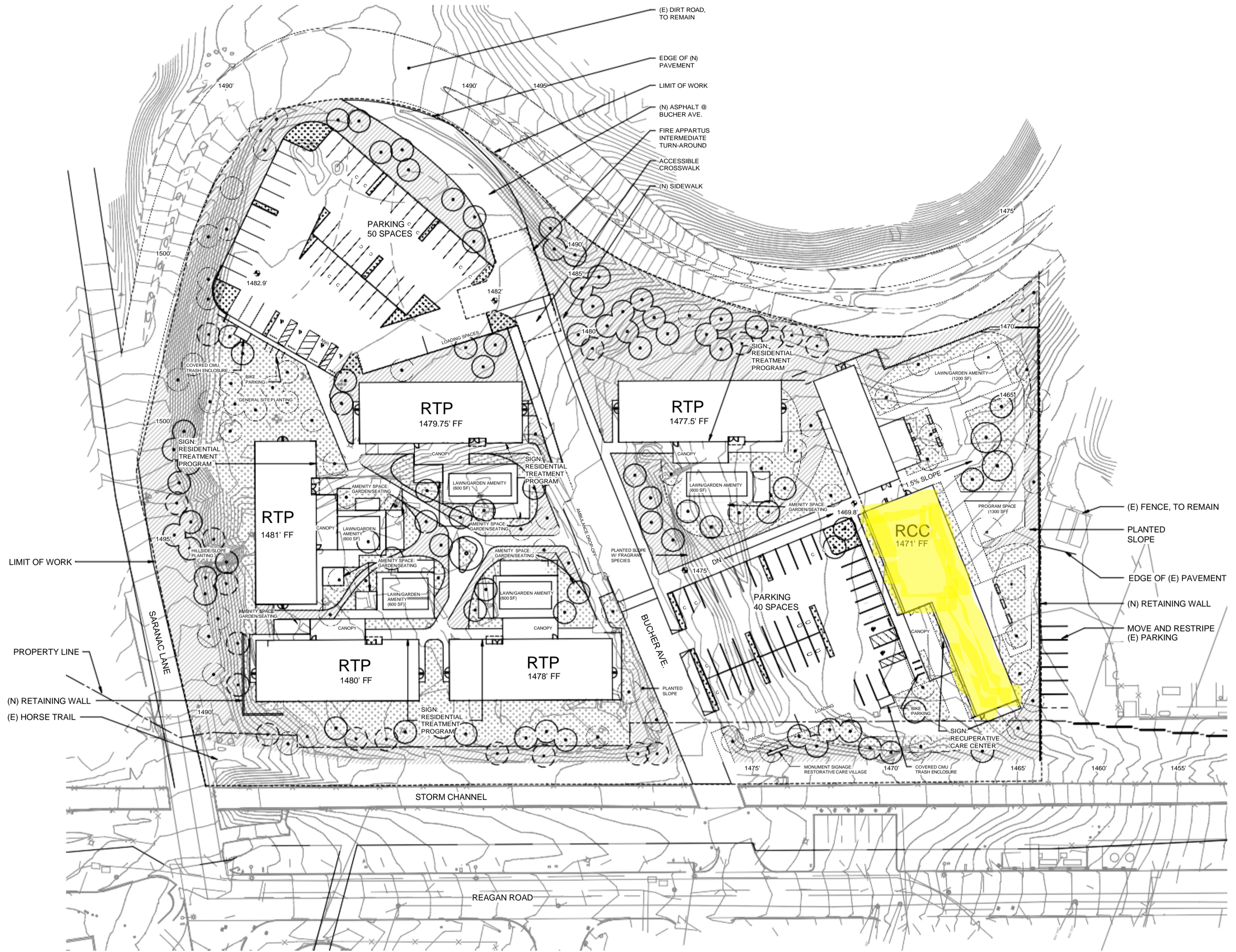

PLAN
TRUE NORTH
SITE PLAN - OPTION 1
Scale: 1/32" = 1'-0"

PROJECT COMPARISONS

CSI LA (ODR) PROJECTS

Rounds 1 and 2

| OLD -Bell Shelter Recuperative Care | NEW-LAC+USC Recuperative Care Center |
|----------------------------------------------------------------------------------------------------------------------------------------------------------------------------------------------------------------------------------------------------------------------------------------------------------------------------------------------------------------------------------------------------------------------------------------------|----------------------------------------------------------------------------------------------------------------------------------------------------------------------------------------------------------------------------------------------------------------------------------------------------------------------------------------------------------------------------------------------------------------------------------------------|
| <u># of Beds:</u> 75 (of 100 total) | <u># of beds:</u> 24 (of 96 total) |
| <u>Projected open date:</u> October 31, 2021 | <u>Projected open date:</u> May 2021 |
| <u>Services:</u> psychiatric, psychological and counseling services, medication monitoring, trauma informed care, substance use treatment (comprehensive assessments, specialized discharge planning, etc), case management, short-term housing with medical oversight for those recovering from acute illness, injury or recent medical procedure and those with complex medical and/or psychiatric illness, and recovery care coordination | <u>Services:</u> psychiatric, psychological and counseling services, medication monitoring, trauma informed care, substance use treatment (comprehensive assessments, specialized discharge planning, etc), case management, short-term housing with medical oversight for those recovering from acute illness, injury or recent medical procedure and those with complex medical and/or psychiatric illness, and recovery care coordination |
| <u>Costs:</u> \$6M for renovation costs. | <u>Costs:</u> \$6,000,000 for 24 of 96 beds to fund renovation costs for a total project cost of \$24,145,000. |

| OLD- Olive View Inpatient Psych beds | NEW- Olive View Recuperative Care Center |
|---------------------------------------------------------------------------------------------------------------------------------------------------------------------------------------------------------|----------------------------------------------------------------------------------------------------------------------------------------------------------------------------------------------------------------------------------------------------------------------------------------------------------------------------------------------------------------------------------------------------------------------------------------------|
| <u># of beds:</u> 25 | <u># of beds:</u> 12 (of 48 total) |
| <u>Projected open date:</u> May 2022 | <u>Projected open date:</u> September 2021 |
| <u>Services:</u> Inpatient psychiatric services, medication monitoring, trauma informed care, substance use treatment (comprehensive assessments, specialized discharge planning, etc), case management | <u>Services:</u> psychiatric, psychological and counseling services, medication monitoring, trauma informed care, substance use treatment (comprehensive assessments, specialized discharge planning, etc), case management, short-term housing with medical oversight for those recovering from acute illness, injury or recent medical procedure and those with complex medical and/or psychiatric illness, and recovery care coordination |
| <u>Costs:</u> \$5,300,945 for renovation and furnishings/equipment costs. | <u>Costs:</u> \$5,300,945 for 12 of 48 beds to fund renovation and furnishing/equipment costs for a total project cost of \$20,537,000. |

Service Comparison
CSI LA-ODR Projects
Rounds 1 and 2

| Category | Services | Bell Shelter Recuperative Care (Initial Round 1) | LAC+USC Recuperative Care Center (New Round 1) | OVMC Inpatient Psychiatric Beds (Initial Round 2) | OVMC Recuperative Care Center (New Round 2) |
|-------------------------------|--------------------------------------------------------------------------------------------------------------------------------------------------------------------------------------------------------------------------------------------------------------------------------------------------------------------------------------------------------|--------------------------------------------------------|------------------------------------------------------|---------------------------------------------------------|---------------------------------------------------|
| Mental Health Services | Inpatient psychiatric care services include those required to licensed psychiatric health facilities. Locked facility | No | No | Yes | No |
| Mental Health Services | Competency restoration according to Misdemeanor Incompetent to Stand Trial and Felony Incompetent to Stand Trial programming. | No | No | Yes | No |
| Mental Health Services | Psychiatric, psychological and counseling services including medication monitoring, behavioral health services - including psychiatry, and individual and group therapy | Yes | Yes | Yes | Yes |
| Medication Monitoring | Assist participant with medication counseling, education and reminders to adhere to treatment regimens. Ensure participants have access to prescribe medications at all times, if being securely stored by facility. Assist participant with maintaining sufficient quantities of all prescribed medications and obtaining refills in a timely manner. | Yes | Yes | Yes | Yes |
| Trauma Informed Care | Providers are training to provide care from a trauma informed and harm reduction perspective | Yes | Yes | Yes | Yes |

Service Comparison
CSI LA-ODR Projects
Rounds 1 and 2

| Category | Services | Bell Shelter Recuperative Care (Initial Round 1) | LAC+USC Recuperative Care Center (New Round 1) | OVMC Inpatient Psychiatric Beds (Initial Round 2) | OVMC Recuperative Care Center (New Round 2) |
|-----------------------------------|----------------------------------------------------------------------------------------------------------------------------------------------------------------------------------------------------------------------------------------------------------------------|--------------------------------------------------------|------------------------------------------------------|---------------------------------------------------------|---------------------------------------------------|
| Substance Use Treatment | Substance abuse treatment services are provided in the unit, including comprehensive assessments, individual substance use counseling, 12 step groups and specialized discharge planning that addresses relapse prevention | Yes | Yes | Yes | Yes |
| Case Management | Patients also receive supportive services, such as case management (including specific experience with the justice-involved population), care coordination, and group activities to enrich patient’s stay within the unit. | Yes | Yes | Yes | Yes |
| Recuperative Care Services | Provide short-term housing with medical oversight to those recovering from an acute illness, injury, or recent medical procedure and those who have complex medical and/or psychiatric illness who would benefit from stabilization during a recuperative care stay. | Yes | Yes | No | Yes |
| Recovery Care Coordination | Ensure participants’ have an appointment with their Primary Care Physician (PCP) of their choice within four weeks of admission to the facility and at least quarterly PCP visit during their interim housing stay. | Yes | Yes | No | Yes |
| Recovery Care Coordination | Provide accompaniment to medical or mental health appointments at least quarterly or more frequently as needed. | Yes | Yes | No | Yes |